

Zástrčka Wi-Fi Pro

Rýchly návod na inštaláciu

2.1 Stiahnite si APLIKÁCIU

Nájdite kód z pravej strany a stiahnite aplikáciu.



SmartESS (iOS)



SmartESS (Android)

lat na

- ① Nájdite zodpovedajúce kód rozhrania v pravej tabuľke podľa modelu datalogger.
- ② Based on the corresponding icon, finish the installation according to the interface code.
- ③ Confirm the status of the LED light (After step 2.3, when 4 LED light keep on, showing the normal

Datalogger Model	Interface Code	Interface Icon
Wi-Fi Plug Pro - 01/11 (Method 1)	1	
Wi-Fi Plug Pro - 04 (Method 2)	2	
Wi-Fi Plug Pro - 02/10/16	3	
Wi-Fi Plug Pro - 07	4	
Wi-Fi Plug Pro - 03/05/06/08/12/13/14/15	4	

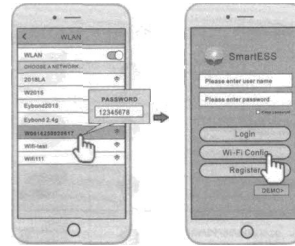

2.2 Pripojenie dataloggeru Wi-Fi

- ① Select the same number of Wi-Fi NN to connect.
- ② Open the APP, click on the Wi-Fi Configuration button to enter this page.



0

Pripojte napájací kábel 4PIN zariadenia Wi-Fi Plug Pro k meniču.
 ① - Fasten the Wi-Fi Plug Pro to the inverter with the screw.

Metóda 2 :

- ① Pripojte 2 PIN zelené rozhranie Wi-Fi Plug Pro k RS-485 svorky meniča.
- ② Connect the SPN wires of the Wi-Fi Plug Pro to the inverter. Attach the Wi-Fi Plug Pro to the inverter with the screw.

2.3 Nastavenie siete

- ① Potom kliknite na položku **Nastavenie siete**.
- ② Podľa výziev zadajte informácie na dokončenie **network setting**.
- ③ After the Wi-Fi Plug Pro is restarted, reconnect the Wi-Fi which connected by step 2.1.

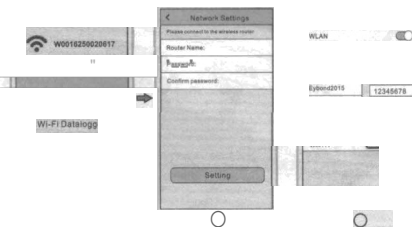

Vytvorenie konta a pridanie dataloggeru

- ① Zarovnajte 4-otvorový leteckú zástrčku Wi-Fi Plug Pro s meničom a plug it in.
- ② Utiahnite maticu zástrčky Wi-Fi Plug Pro na meniči.

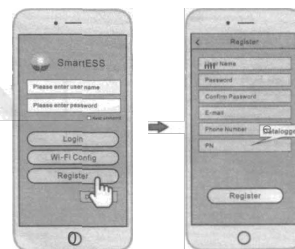
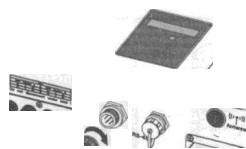

3.1 Vytvoriť účet

- ① Open the APP, tap the Register button.
- ② According to the instructions, enter the information to create the account.



0

① Ign RJ-4s crystal head or Wi-Fi Plug Pro with the inverter and insert it into the screw.

3.2 Pridať datalogger

- ① Log in to the account and click on the **Datalogger** button. Click on the "+" button on the top-right corner of the **Datalogger** page.
- ② Scan the PN on the Wi-Fi Plug Pro device or enter it manually.
- ③ According to the instructions, enter the information to complete the addition.

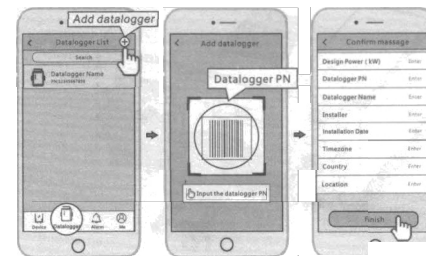

- ① Align the serial port of the Wi-Fi Plug Pro with the inverter and plug it in tightly.
- ② Attach the Wi-Fi Plug Pro to the inverter with the screw.

